

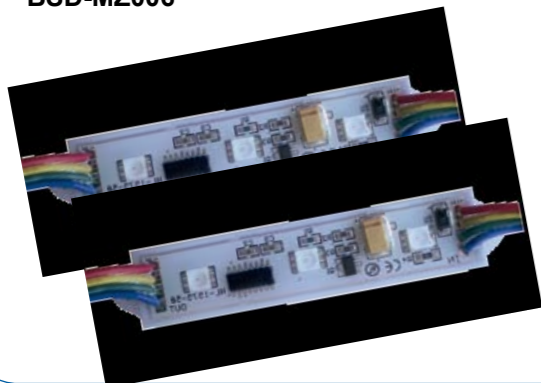

LED 模组

LED Module

BSD-MZ006



产品特点 Product Features

具有体积小、安全低电压、寿命长、电光转换效率高、响应速度快、节能、环保等优良特性，能适应各种几何尺寸和不同空间大小的装饰照明要求，LED模组光照强、光色一致性佳、色彩饱和度好、寿命长、抗震好，低光衰。安装维护成本低。

It has lots of advantages, such as small size, safe low voltage, long lifespan, high electro-optic conversion efficiency, high response speed, energy saving, environmental protection. It can meet all the decorative lighting requirements of different geometric dimensions and space sizes. LED module has good light color consistence, excellent color saturation, long lifespan, good anti-seismic, low luminous decay and low maintenance cost.

应用场合 Applications

主要用于展示广告字体和标识的夜间效果，它以文字或标识为媒介，安装在楼宇顶部或墙面。

Apply to displaying advertising characters and marks at night. Using words or marks as media, which is installed in the building top or metope.

规格参数 Specifications

材 料 Material	FR-4
防护等级 IP Rating	IP65
功 率 Power (W)	1W
输入电压 Input Voltage (V)	12
光源类型 Light source Type	5050 LED
芯片尺寸 Chip Size (mil)	12*12
光源数量 Light Source Quantity (pcs)	3
光源光效 Luminous Efficiency (Lm/W)	90-130
显色指数 CRI	—
色 温 Color Temp (k)	全彩 Full Color
环境温度 Environment Temperature (°C)	-40~45
使用寿命 Lifespan (h)	30000-80000



配光曲线 Light Distribution Curve

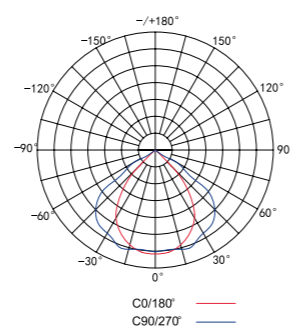

外形尺寸图 Dimension Diagram

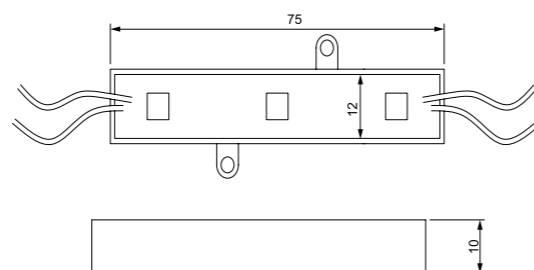

包装参数 Packaging Parameters

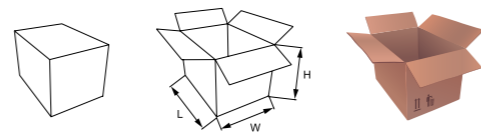

Item	Size(mm)	包装数量 Qty	外箱尺寸 Carton Size
BSD-MZ006		1000PCS	415L×315W×165H

LED 模组

LED Module



BSD-MZ007



产品特点 Product Features

具有体积小、安全低电压、寿命长、电光转换效率高、响应速度快、节能、环保等优良特性，能适应各种几何尺寸和不同空间大小的装饰照明要求，LED模组光照强、光色一致性佳、色彩饱和度好、寿命长、抗震好，低光衰。安装维护成本低。

It has lots of advantages, such as small size, safe low voltage, long lifespan, high electro-optic conversion efficiency, high response speed, energy saving, environmental protection. It can meet all the decorative lighting requirements of different geometric dimensions and space sizes. LED module has good light color consistence, excellent color saturation, long lifespan, good anti-seismic, low luminous decay and low maintenance cost.

应用场合 Applications

主要用于展示广告字体和标识的夜间效果，它以文字或标识为媒介，安装在楼宇顶部或墙面。

Apply to displaying advertising characters and marks at night. Using words or marks as media, which is installed in the building top or metope.

规格参数 Specifications

材 料 Material	FR-4
防护等级 IP Rating	IP65
功 率 Power (W)	0.24W
输入电压 Input Voltage (V)	12
光源类型 Light source Type	5050 LED
芯片尺寸 Chip Size (mil)	12*12
光源数量 Light Source Quantity (pcs)	2
光源光效 Luminous Efficiency (Lm/W)	90-130
显色指数 CRI	—
色 温 Color Temp (k)	R / Y / G / B / W
环境温度 Environment Temperature (°C)	-40~45
使用寿命 Lifespan (h)	30000-80000

配光曲线 Light Distribution Curve

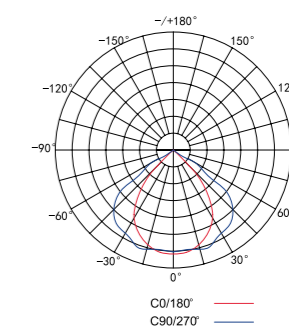

外形尺寸图 Dimension Diagram

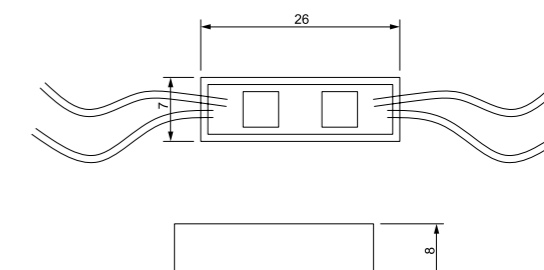

包装参数 Packaging Parameters

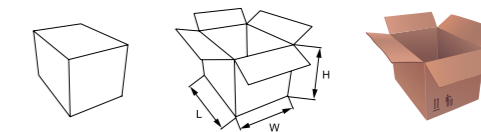

Item	Size(mm)	包装数量 Qty	外箱尺寸 Carton Size
BSD-MZ007		4000PCS	315L×215W×200H



LED 模组

LED Module

BSD-MZ008



产品特点 Product Features

具有体积小、安全低电压、寿命长、电光转换效率高、响应速度快、节能、环保等优良特性，能适应各种几何尺寸和不同空间大小的装饰照明要求，LED模组光照强、光色一致性佳、色彩饱和度好、寿命长、抗震好，低光衰。安装维护成本低。

It has lots of advantages, such as small size, safe low voltage, long lifespan, high electro-optic conversion efficiency, high response speed, energy saving, environmental protection. It can meet all the decorative lighting requirements of different geometric dimensions and space sizes. LED module has good light color consistence, excellent color saturation, long lifespan, good anti-seismic, low luminous decay and low maintenance cost.

应用场合 Applications

主要用于展示广告字体和标识的夜间效果，它以文字或标识为媒介，安装在楼宇顶部或墙面。

Apply to displaying advertising characters and marks at night. Using words or marks as media, which is installed in the building top or metope.

规格参数 Specifications

材 料 Material	FR-4
防护等级 IP Rating	IP65
功 率 Power (W)	0.24W
输入电压 Input Voltage (V)	12
光源类型 Light source Type	5050 LED
芯片尺寸 Chip Size (mil)	12*12
光源数量 Light Source Quantity (pcs)	3
光源光效 Luminous Efficiency (Lm/W)	90-130
显色指数 CRI	—
色 温 Color Temp (k)	R / Y / G / B / W
环境温度 Environment Temperature (°C)	-40~45
使用寿命 Lifespan (h)	30000-80000



配光曲线 Light Distribution Curve

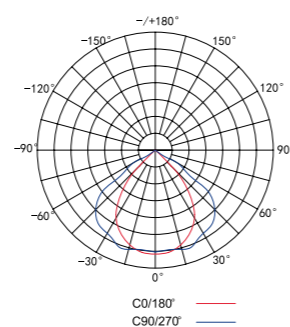

外形尺寸图 Dimension Diagram

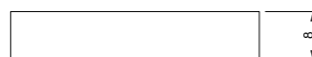
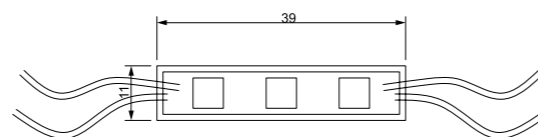

包装参数 Packaging Parameters

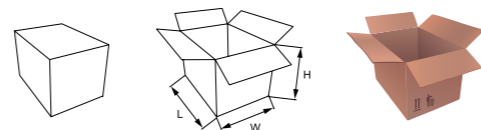

Item	Size(mm)	包装数量 Qty	外箱尺寸 Carton Size
BSD-MZ008		4000PCS	420L×315W×220H



产品特点 Product Features

具有体积小、安全低电压、寿命长、电光转换效率高、响应速度快、节能、环保等优良特性，能适应各种几何尺寸和不同空间大小的装饰照明要求，LED模组光照强、光色一致性佳、色彩饱和度好、寿命长、抗震好，低光衰。安装维护成本低。

It has lots of advantages, such as small size, safe low voltage, long lifespan, high electro-optic conversion efficiency, high response speed, energy saving, environmental protection. It can meet all the decorative lighting requirements of different geometric dimensions and space sizes. LED module has good light color consistence, excellent color saturation, long lifespan, good anti-seismic, low luminous decay and low maintenance cost.

应用场合 Applications

主要用于展示广告字体和标识的夜间效果，它以文字或标识为媒介，安装在楼宇顶部或墙面。

Apply to displaying advertising characters and marks at night. Using words or marks as media, which is installed in the building top or metope.

规格参数 Specifications

材 料 Material	FR-4
防护等级 IP Rating	IP65
功 率 Power (W)	0.24W
输入电压 Input Voltage (V)	12
光源类型 Light source Type	3528 LED
芯片尺寸 Chip Size (mil)	12*12
光源数量 Light Source Quantity (pcs)	3
光源光效 Luminous Efficiency (Lm/W)	90-130
显色指数 CRI	—
色 温 Color Temp (k)	R / Y / G / B / W
环境温度 Environment Temperature (°C)	-40~45
使用寿命 Lifespan (h)	30000-80000

LED 模组

LED Module



BSD-MZ009



配光曲线 Light Distribution Curve

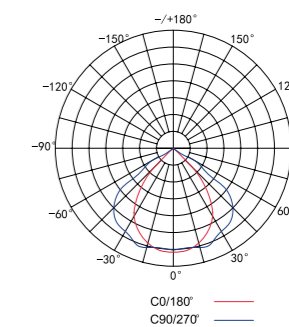

外形尺寸图 Dimension Diagram

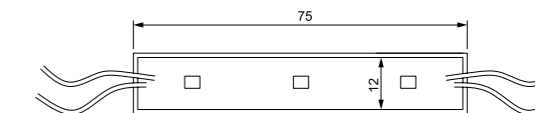

包装参数 Packaging Parameters

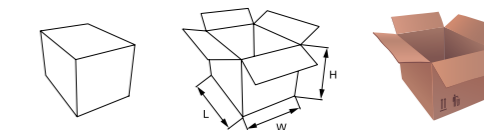

Item	Size(mm)	包装数量 Qty	外箱尺寸 Carton Size
BSD-MZ009		2000PCS	420L×315W×220H



LED 模组

LED Module

BSD-MZ010



产品特点 Product Features

具有体积小、安全低电压、寿命长、电光转换效率高、响应速度快、节能、环保等优良特性，能适应各种几何尺寸和不同空间大小的装饰照明要求，LED模组光照强、光色一致性佳、色彩饱和度好、寿命长、抗震好，低光衰。安装维护成本低。

It has lots of advantages, such as small size, safe low voltage, long lifespan, high electro-optic conversion efficiency, high response speed, energy saving, environmental protection. It can meet all the decorative lighting requirements of different geometric dimensions and space sizes. LED module has good light color consistence, excellent color saturation, long lifespan, good anti-seismic, low luminous decay and low maintenance cost.

应用场合 Applications

主要用于展示广告字体和标识的夜间效果，它以文字或标识为媒介，安装在楼宇顶部或墙面。

Apply to displaying advertising characters and marks at night. Using words or marks as media, which is installed in the building top or metope.

规格参数 Specifications

材料 Material	FR-4
防护等级 IP Rating	IP65
功率 Power (W)	0.72W
输入电压 Input Voltage (V)	12
光源类型 Light source Type	5050 LED
芯片尺寸 Chip Size (mil)	12*12
光源数量 Light Source Quantity (pcs)	3
光源光效 Luminous Efficiency (Lm/W)	90-130
显色指数 CRI	—
色温 Color Temp (k)	R / Y / G / B / W
环境温度 Environment Temperature (°C)	-40~45
使用寿命 Lifespan (h)	30000-80000



配光曲线 Light Distribution Curve

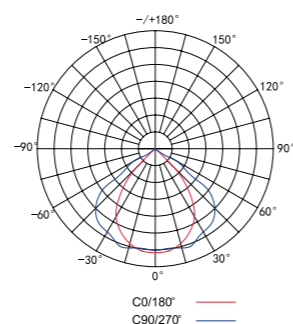

外形尺寸图 Dimension Diagram

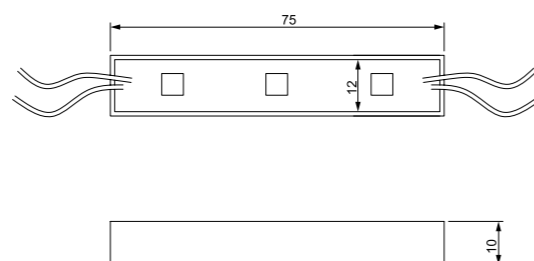

包装参数 Packaging Parameters

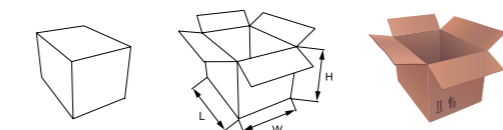

Item	Size(mm)	包装数量 Qty	外箱尺寸 Carton Size
BSD-MZ010		2000PCS	420L×315W×220H



LED 软灯带

LED Flexible strip



应用场合 Applications

用于路径和轮廓标志，广告招牌等精品装饰领域。

Apply to routes, profile marks, billboards and boutique decoration areas.

规格参数 Specifications

材料 Material	FPC
防护等级 IP Rating	IP40
功率 Power (W)	4.2 / 2.1W
输入电压 Input Voltage (V)	12
光源类型 Light source Type	3528SMD
芯片尺寸 Chip Size (mil)	12*12
光源数量 Light Source Quantity (pcs)	60 / 30
光源光效 Luminous Efficiency (Lm/W)	90-130
显色指数 CRI	—
色温 Color Temp (k)	R Y B G W
环境温度 Environment Temperature (°C)	-40~45
使用寿命 Lifespan (h)	30000-80000



BSD-RDD001 BSD-RDD002



产品特点 Product Features

每三个LED可以为一段，软性印制电路板，背面带双面胶，用于粘贴，体积小，安装方便；发光颜色：红/黄/蓝/绿/白/暖白多种颜色。

Every three led beads can be one section, soft PCB, with double-sided paster on the back for pasting, small size and easy to install. Light color : red/yellow/blue/green/white/warm white.

安装示意图 Installation Diagram

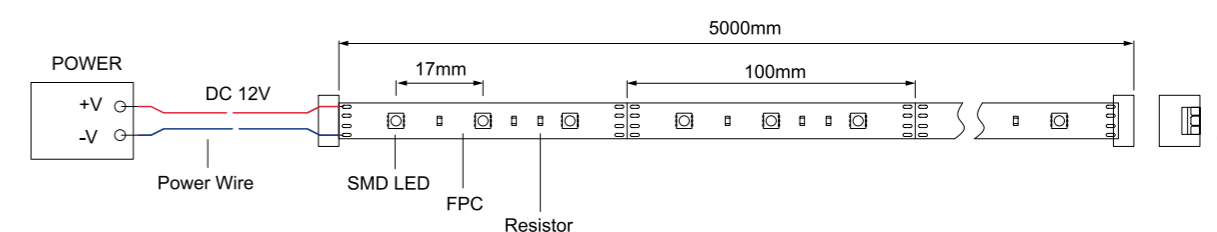



LED 软灯带

LED Flexible strip



BSD-RDD003
BSD-RDD004



产品特点 Product Features

每三个LED可以为一段，软性印制电路板，背面带双面胶，用于粘贴，体积小，安装方便；发光颜色：红/黄/蓝/绿/白/暖白多种颜色。

Every three led beads can be one section, soft PCB, with double-sided paster on the back for pasting, small size and easy to install. Light color : red/yellow/blue/green/white/warm white.

安装示意图 Installation Diagram

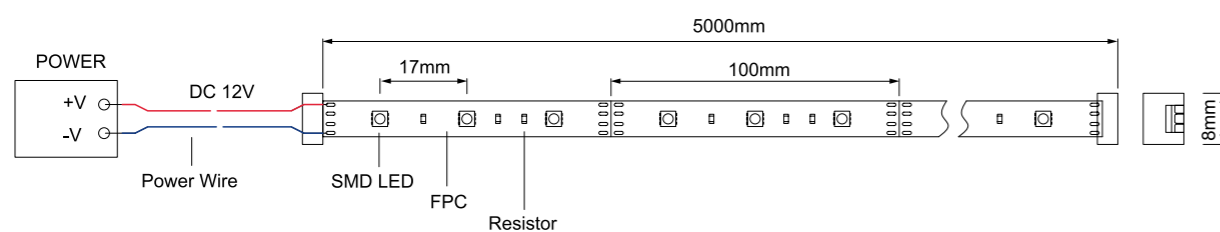

LED 软灯带

LED Flexible strip



应用场合 Applications

用于路径和轮廓标志，广告招牌等精品装饰领域。

Apply to routes, profile marks, billboards and boutique decoration areas.

规格参数 Specifications

材 料 Material	FPC
防护等级 IP Rating	IP44
功 率 Power (W)	4.2 / 2.1W
输入电压 Input Voltage (V)	12
光源类型 Light source Type	3528SMD
芯片尺寸 Chip Size (mil)	12*12
光源数量 Light Source Quantity (pcs)	60 / 30
光源光效 Luminous Efficiency (Lm/W)	90-130
显色指数 CRI	—
色 温 Color Temp (k)	R Y B G W
环境温度 Environment Temperature (°C)	-40~45
使用寿命 Lifespan (h)	30000-80000

应用场合 Applications

用于路径和轮廓标志，广告招牌等精品装饰领域。

Apply to routes, profile marks, billboards and boutique decoration areas.

规格参数 Specifications

材 料 Material	FPC
防护等级 IP Rating	IP40
功 率 Power (W)	12.8 / 6.4W
输入电压 Input Voltage (V)	12
光源类型 Light source Type	5050SMD
芯片尺寸 Chip Size (mil)	12*12
光源数量 Light Source Quantity (pcs)	60 / 30
光源光效 Luminous Efficiency (Lm/W)	90-130
显色指数 CRI	—
色 温 Color Temp (k)	R Y B G W
环境温度 Environment Temperature (°C)	-40~45
使用寿命 Lifespan (h)	30000-80000

BSD-RDD005
BSD-RDD006



产品特点 Product Features

每三个LED可以为一段，软性印制电路板，背面带双面胶，用于粘贴，体积小，安装方便；发光颜色：红/黄/蓝/绿/白/暖白多种颜色。

Every three led beads can be one section, soft PCB, with double-sided paster on the back for pasting, small size and easy to install. Light color : red/yellow/blue/green/white/warm white.

安装示意图 Installation Diagram

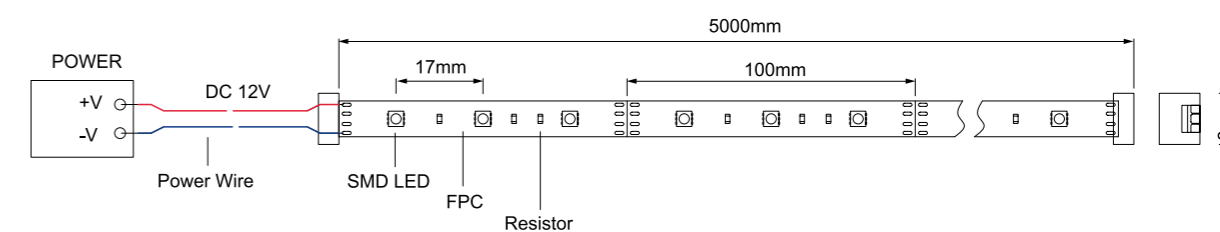



LED 软灯带

LED Flexible strip



BSD-RDD007
BSD-RDD008



产品特点 Product Features

每三个LED可以为一段，软性印制电路板，背面带双面胶，用于粘贴，体积小，安装方便；发光颜色：红/黄/蓝/绿/白/暖白多种颜色。

Every three led beads can be one section, soft PCB, with double-sided paster on the back for pasting, small size and easy to install. Light color : red/yellow/blue/green/white/warm white.

安装示意图 Installation Diagram

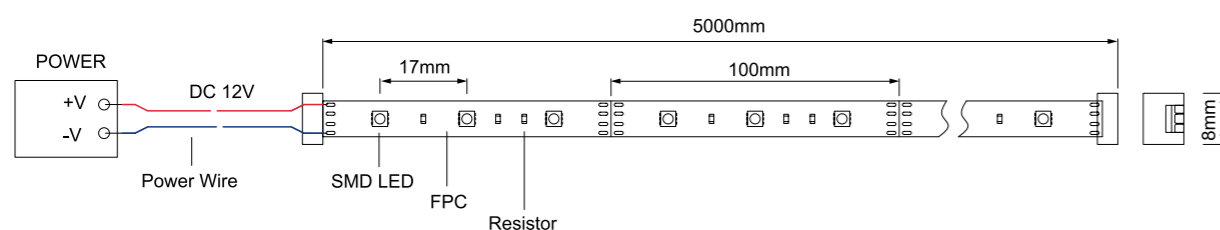

应用场合 Applications

用于路径和轮廓标志，广告招牌等精品装饰领域。

Apply to routes, profile marks, billboards and boutique decoration areas.

规格参数 Specifications

材 料 Material	FPC
防护等级 IP Rating	IP44
功 率 Power (W)	12.8 / 6.4W
输入电压 Input Voltage (V)	12
光源类型 Light source Type	5050SMD
芯片尺寸 Chip Size (mil)	12*12
光源数量 Light Source Quantity (pcs)	60 / 30
光源光效 Luminous Efficiency (Lm/W)	90-130
显色指数 CRI	—
色 温 Color Temp (k)	R Y B G W
环境温度 Environment Temperature (°C)	-40~45
使用寿命 Lifespan (h)	30000-80000



LED 流星雨

LED Meteor Shower



产品特点 Product Features

流星效果，浪漫唯美；外带驱动，低压供电，可根据需求任意增减灯管数量，随意发挥；防水、防尘、防腐蚀，不受时间、空间限制。

Meteor effect, romantic and aesthetic, external driving, low-voltage power supply, the quantity can be added or reduced according to the demand. Waterproof, dustproof, corrosion resistance, without time and space limited.

应用场合 Applications

市场工程亮化,建筑装饰、街道两旁树木装饰、公园装饰、江边装饰、城市夜景亮化,旅游景点美化,园林、社区夜晶装饰,酒店、商场、娱乐场所周遍环境夜景装饰,家居装饰。

Apply to market engineering lighting, decoration of architecture, street, park and river, urban night lighting, scenic spot lighting, community night scene, garden, hotel, shopping mall, decorative lighting of entertainment place and home decoration.

规格参数 Specifications

材 料 Material	FR-4
防护等级 IP Rating	IP65
功 率 Power (W)	0.2W
输入电压 Input Voltage (V)	6
光源类型 Light source Type	DIP LED
芯片尺寸 Chip Size (mil)	12*12
光源数量 Light Source Quantity (pcs)	20
光源光效 Luminous Efficiency (Lm/W)	90-130
显色指数 CRI	—
色 温 Color Temp (k)	R / Y / G / B / W
环境温度 Environment Temperature (°C)	-40~45
使用寿命 Lifespan (h)	30000-80000

BSD-LXY001



外形尺寸图 Dimension Diagram

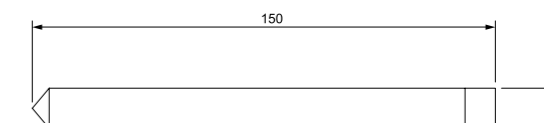

包装参数 Packaging Parameters

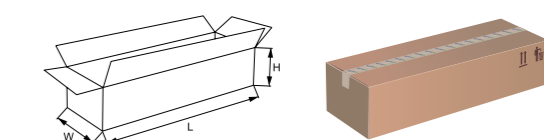

Item	Size(mm)	包装数量 Qty	外箱尺寸 Carton Size
BSD-LXY001		18PCS	520L×300W×300H



LED 流星雨

LED Meteor Shower



LED 流星雨

LED Meteor Shower

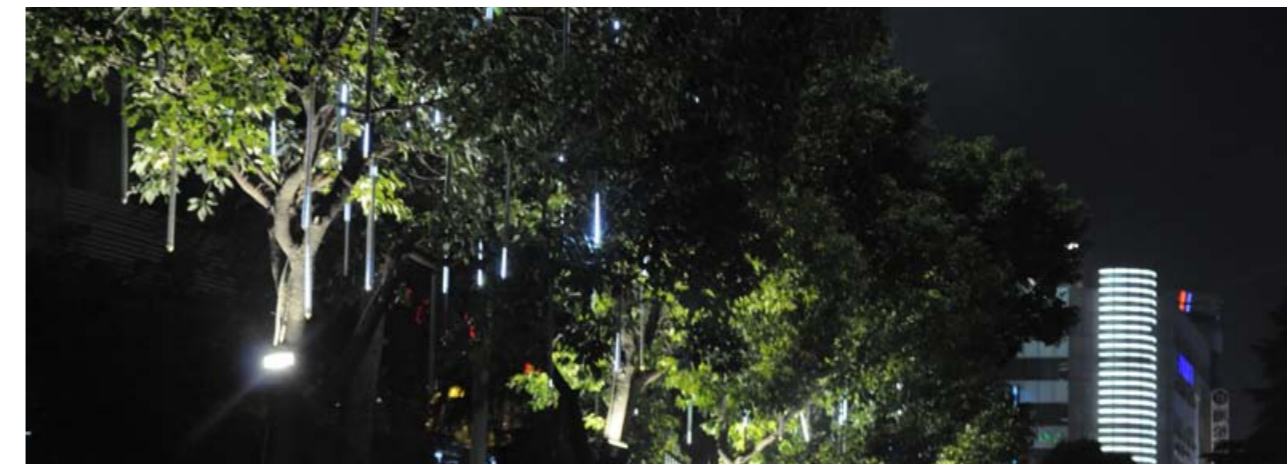

BSD-LXY002

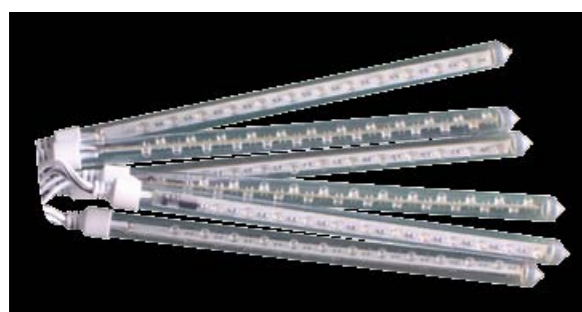

外形尺寸图 Dimension Diagram

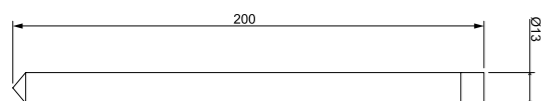

包装参数 Packaging Parameters

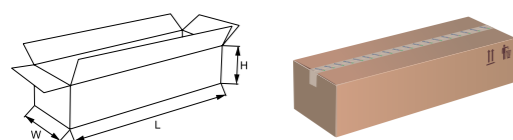

Item	Size(mm)	包装数量 Qty	外箱尺寸 Carton Size
BSD-LXY002		20PCS	570L×340W×220H

产品特点 Product Features

流星效果，浪漫唯美；外带驱动，低压供电，可根据需求任意增减灯管数量，随意发挥；防水、防尘、防腐蚀，不受时间、空间限制。

Meteor effect, romantic and aesthetic, external driving, low-voltage power supply, the quantity can be added or reduced according to the demand. Waterproof, dustproof, corrosion resistance, without time and space limited.

应用场合 Applications

市场工程亮化, 建筑装饰、街道两旁树木装饰、公园装饰、江边装饰、城市夜景亮化, 旅游景点美化, 园林、社区夜晶装饰, 酒店、商场、娱乐场所周边环境夜景装饰, 家居装饰.

Apply to market engineering lighting, decoration of architecture, street, park and river, urban night lighting, scenic spot lighting, community night scene, garden, hotel, shopping mall, decorative lighting of entertainment place and home decoration.

规格参数 Specifications

材 料 Material	FR-4
防护等级 IP Rating	IP65
功 率 Power (W)	0.24W
输入电压 Input Voltage (V)	6
光源类型 Light source Type	DIP LED
芯片尺寸 Chip Size (mil)	12*12
光源数量 Light Source Quantity (pcs)	24
光源光效 Luminous Efficiency (Lm/W)	90-130
显色指数 CRI	—
色 温 Color Temp (k)	R / Y / G / B / W
环境温度 Environment Temperature (°C)	-40~45
使用寿命 Lifespan (h)	30000-80000

产品特点 Product Features

流星效果，浪漫唯美；外带驱动，低压供电，可根据需求任意增减灯管数量，随意发挥；防水、防尘、防腐蚀，不受时间、空间限制。

Meteor effect, romantic and aesthetic, external driving, low-voltage power supply, the quantity can be added or reduced according to the demand. Waterproof, dustproof, corrosion resistance, without time and space limited.

应用场合 Applications

市场工程亮化, 建筑装饰、街道两旁树木装饰、公园装饰、江边装饰、城市夜景亮化, 旅游景点美化, 园林、社区夜晶装饰, 酒店、商场、娱乐场所周边环境夜景装饰, 家居装饰.

Apply to market engineering lighting, decoration of architecture, street, park and river, urban night lighting, scenic spot lighting, community night scene, garden, hotel, shopping mall, decorative lighting of entertainment place and home decoration.

规格参数 Specifications

材 料 Material	FR-4
防护等级 IP Rating	IP65
功 率 Power (W)	0.32W
输入电压 Input Voltage (V)	6
光源类型 Light source Type	DIP LED
芯片尺寸 Chip Size (mil)	12*12
光源数量 Light Source Quantity (pcs)	32
光源光效 Luminous Efficiency (Lm/W)	90-130
显色指数 CRI	—
色 温 Color Temp (k)	R / Y / G / B / W
环境温度 Environment Temperature (°C)	-40~45
使用寿命 Lifespan (h)	30000-80000

BSD-LXY003

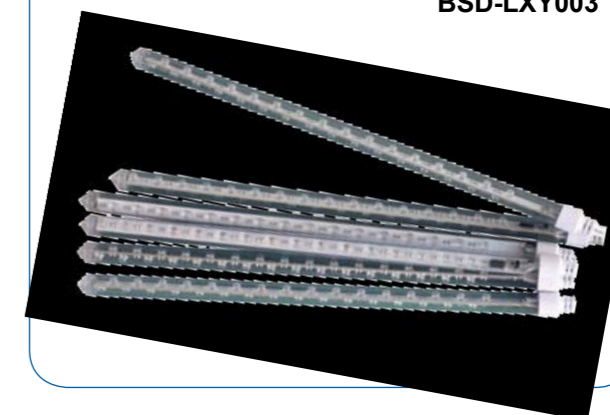

外形尺寸图 Dimension Diagram

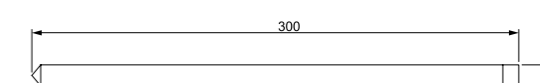

包装参数 Packaging Parameters

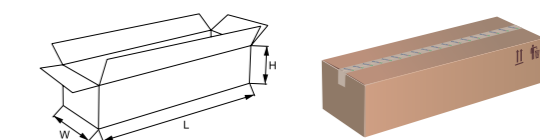

Item	Size(mm)	包装数量 Qty	外箱尺寸 Carton Size
BSD-LXY003		10PCS	570L×340W×220H



LED 流星雨

LED Meteor Shower



BSD-LXY004

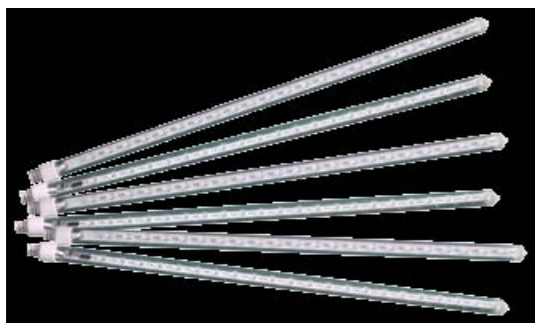

外形尺寸图 Dimension Diagram

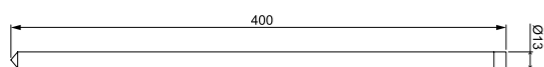

包装参数 Packaging Parameters

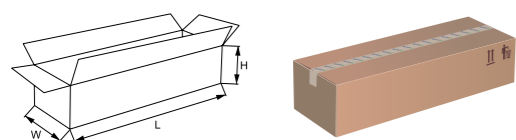

Item	Size(mm)	包装数量 Qty	外箱尺寸 Carton Size
BSD-LXY004		10PCS	570L×340W×220H

产品特点 Product Features

流星效果, 浪漫唯美; 外带驱动, 低压供电, 可根据需求任意增减灯管数量, 随意发挥; 防水、防尘、防腐蚀, 不受时间、空间限制。

Meteor effect, romantic and aesthetic, external driving, low-voltage power supply, the quantity can be added or reduced according to the demand. Waterproof, dustproof, corrosion resistance, without time and space limited.

应用场合 Applications

市场工程亮化, 建筑装饰、街道两旁树木装饰、公园装饰、江边装饰、城市夜景亮化, 旅游景点美化, 园林、社区夜晶装饰, 酒店、商场、娱乐场所周边环境夜景装饰, 家居装饰。

Apply to market engineering lighting, decoration of architecture, street, park and river, urban night lighting, scenic spot lighting, community night scene, garden, hotel, shopping mall, decorative lighting of entertainment place and home decoration.

规格参数 Specifications

材 料 Material	FR-4
防护等级 IP Rating	IP65
功 率 Power (W)	0.44W
输入电压 Input Voltage (V)	6
光源类型 Light source Type	DIP LED
芯片尺寸 Chip Size (mil)	12*12
光源数量 Light Source Quantity (pcs)	44
光源光效 Luminous Efficiency (Lm/W)	90-130
显色指数 CRI	—
色 温 Color Temp (k)	R / Y / G / B / W
环境温度 Environment Temperature (°C)	-40~45
使用寿命 Lifespan (h)	30000-80000



LED 流星雨

LED Meteor Shower

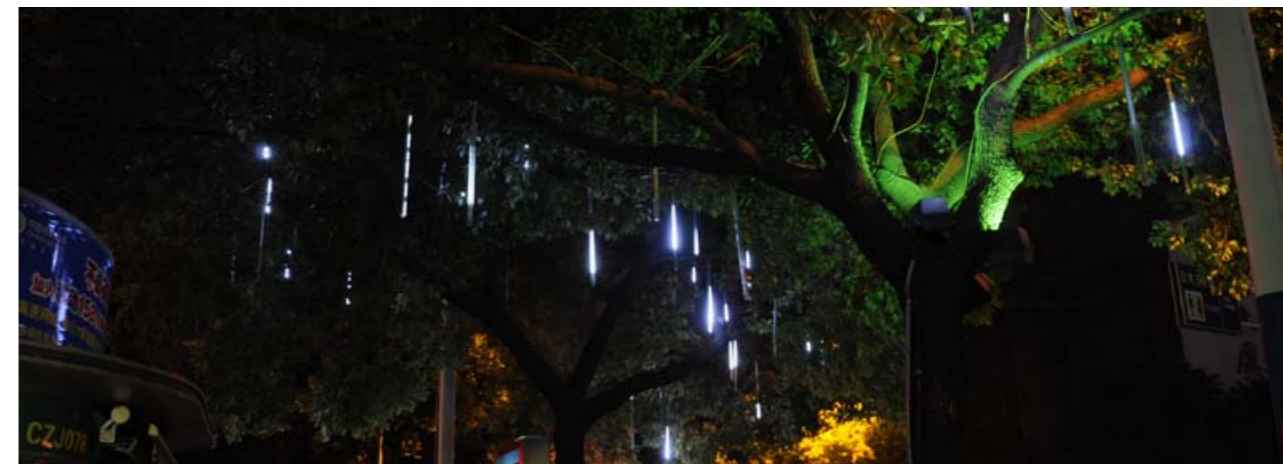

产品特点 Product Features

流星效果, 浪漫唯美; 外带驱动, 低压供电, 可根据需求任意增减灯管数量, 随意发挥; 防水、防尘、防腐蚀, 不受时间、空间限制。

Meteor effect, romantic and aesthetic, external driving, low-voltage power supply, the quantity can be added or reduced according to the demand. Waterproof, dustproof, corrosion resistance, without time and space limited.

应用场合 Applications

市场工程亮化, 建筑装饰、街道两旁树木装饰、公园装饰、江边装饰、城市夜景亮化, 旅游景点美化, 园林、社区夜晶装饰, 酒店、商场、娱乐场所周边环境夜景装饰, 家居装饰。

Apply to market engineering lighting, decoration of architecture, street, park and river, urban night lighting, scenic spot lighting, community night scene, garden, hotel, shopping mall, decorative lighting of entertainment place and home decoration.

规格参数 Specifications

材 料 Material	FR-4
防护等级 IP Rating	IP65
功 率 Power (W)	1.08W
输入电压 Input Voltage (V)	12
光源类型 Light source Type	DIP LED
芯片尺寸 Chip Size (mil)	12*12
光源数量 Light Source Quantity (pcs)	108
光源光效 Luminous Efficiency (Lm/W)	90-130
显色指数 CRI	—
色 温 Color Temp (k)	R / Y / G / B / W
环境温度 Environment Temperature (°C)	-40~45
使用寿命 Lifespan (h)	30000-80000

BSD-LXY005

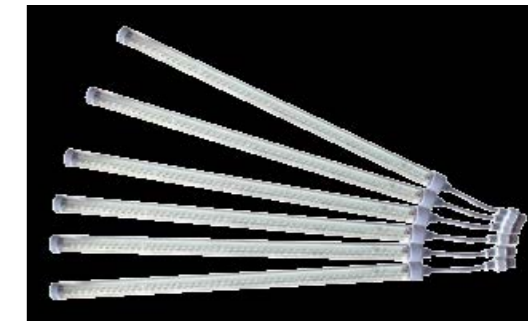

外形尺寸图 Dimension Diagram

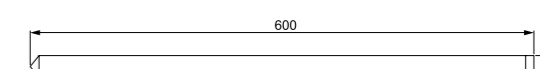

包装参数 Packaging Parameters

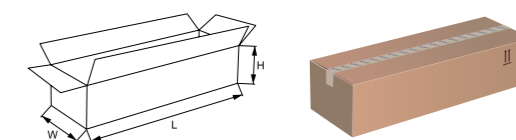

Item	Size(mm)	包装数量 Qty	外箱尺寸 Carton Size
BSD-LXY005		4PCS	630L×280W×315H



LED 流星雨

LED Meteor Shower

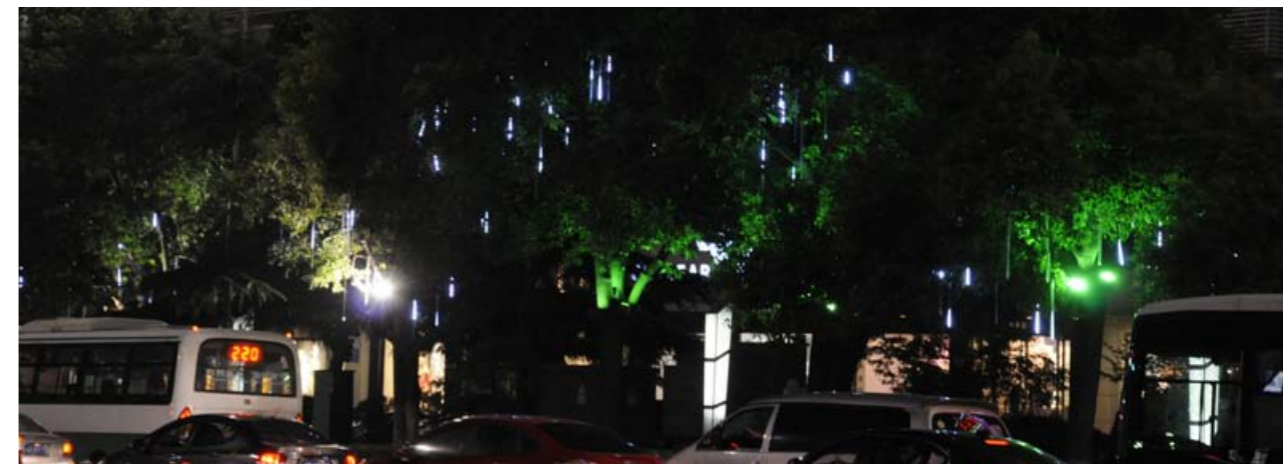

LED 流星雨

LED Meteor Shower



BSD-LXY006

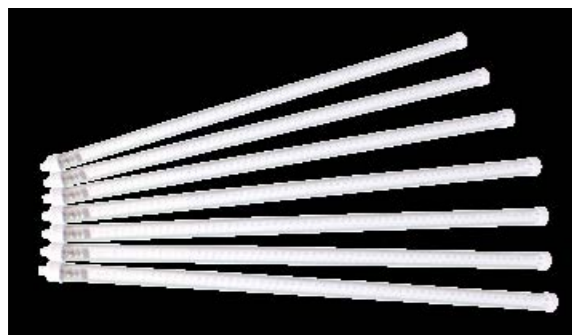

外形尺寸图 Dimension Diagram

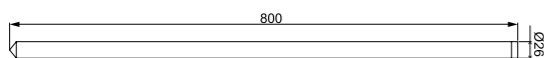

包装参数 Packaging Parameters

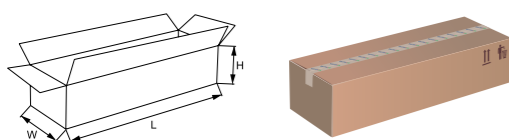

Item	Size(mm)	包装数量 Qty	外箱尺寸 Carton Size
BSD-LXY006		4PCS	830L×280W×315H

产品特点 Product Features

流星效果，浪漫唯美；外带驱动，低压供电，可根据需求任意增减灯管数量，随意发挥；防水、防尘、防腐蚀，不受时间、空间限制。

Meteor effect, romantic and aesthetic, external driving, low-voltage power supply, the quantity can be added or reduced according to the demand. Waterproof, dustproof, corrosion resistance, without time and space limited.

应用场合 Applications

市场工程亮化, 建筑装饰、街道两旁树木装饰、公园装饰、江边装饰、城市夜景亮化, 旅游景点美化, 园林、社区夜晶装饰, 酒店、商场、娱乐场所周边环境夜景装饰, 家居装饰.

Apply to market engineering lighting, decoration of architecture, street, park and river, urban night lighting, scenic spot lighting, community night scene, garden, hotel, shopping mall, decorative lighting of entertainment place and home decoration.

规格参数 Specifications

材 料 Material	FR-4
防护等级 IP Rating	IP65
功 率 Power (W)	1.2W
输入电压 Input Voltage (V)	12
光源类型 Light source Type	DIP LED
芯片尺寸 Chip Size (mil)	12*12
光源数量 Light Source Quantity (pcs)	120
光源光效 Luminous Efficiency (Lm/W)	90-130
显色指数 CRI	—
色 温 Color Temp (k)	R / Y / G / B / W
环境温度 Environment Temperature (°C)	-40~45
使用寿命 Lifespan (h)	30000-80000

产品特点 Product Features

流星效果，浪漫唯美；外带驱动，低压供电，可根据需求任意增减灯管数量，随意发挥；防水、防尘、防腐蚀，不受时间、空间限制。

Meteor effect, romantic and aesthetic, external driving, low-voltage power supply, the quantity can be added or reduced according to the demand. Waterproof, dustproof, corrosion resistance, without time and space limited.

应用场合 Applications

市场工程亮化, 建筑装饰、街道两旁树木装饰、公园装饰、江边装饰、城市夜景亮化, 旅游景点美化, 园林、社区夜晶装饰, 酒店、商场、娱乐场所周边环境夜景装饰, 家居装饰.

Apply to market engineering lighting, decoration of architecture, street, park and river, urban night lighting, scenic spot lighting, community night scene, garden, hotel, shopping mall, decorative lighting of entertainment place and home decoration.

规格参数 Specifications

材 料 Material	FR-4
防护等级 IP Rating	IP65
功 率 Power (W)	1.2W
输入电压 Input Voltage (V)	12
光源类型 Light source Type	DIP LED
芯片尺寸 Chip Size (mil)	12*12
光源数量 Light Source Quantity (pcs)	120
光源光效 Luminous Efficiency (Lm/W)	90-130
显色指数 CRI	—
色 温 Color Temp (k)	R / Y / G / B / W
环境温度 Environment Temperature (°C)	-40~45
使用寿命 Lifespan (h)	30000-80000

BSD-LXY007

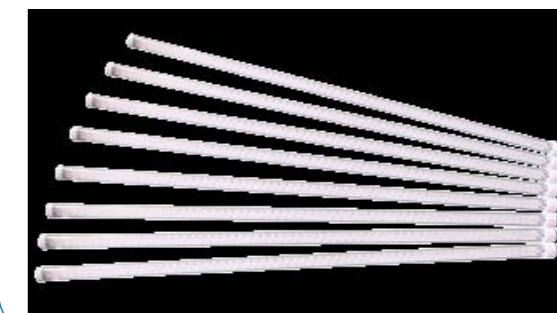

外形尺寸图 Dimension Diagram

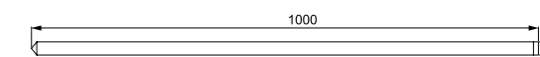

包装参数 Packaging Parameters

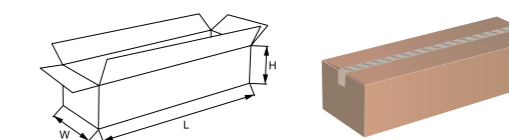

Item	Size(mm)	包装数量 Qty	外箱尺寸 Carton Size
BSD-LXY007		4PCS	1180L×280W×315H



LED 流星雨

LED Meteor Shower



BSD-LXY008

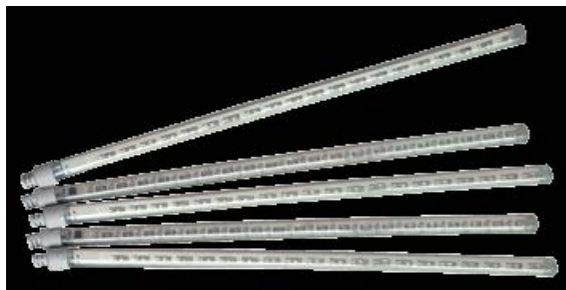

外形尺寸图 Dimension Diagram

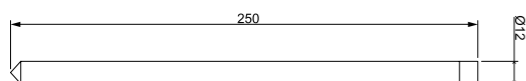

包装参数 Packaging Parameters

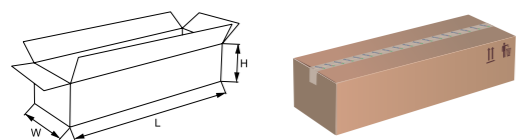

Item	Size(mm)	包装数量 Qty	外箱尺寸 Carton Size
BSD-LXY008		20PCS	630L×340W×220H

产品特点 Product Features

流星效果，浪漫唯美；外带驱动，低压供电，可根据需求任意增减灯管数量，随意发挥；防水、防尘、防腐蚀，不受时间、空间限制。

Meteor effect, romantic and aesthetic, external driving, low-voltage power supply, the quantity can be added or reduced according to the demand. Waterproof, dustproof, corrosion resistance, without time and space limited.

应用场合 Applications

市场工程亮化, 建筑装饰、街道两旁树木装饰、公园装饰、江边装饰、城市夜景亮化, 旅游景点美化, 园林、社区夜晶装饰, 酒店、商场、娱乐场所周边环境夜景装饰, 家居装饰.

Apply to market engineering lighting, decoration of architecture, street, park and river, urban night lighting, scenic spot lighting, community night scene, garden, hotel, shopping mall, decorative lighting of entertainment place and home decoration.

规格参数 Specifications

材 料 Material	FR-4
防护等级 IP Rating	IP65
功 率 Power (W)	0.2W
输入电压 Input Voltage (V)	24
光源类型 Light source Type	DIP LED
芯片尺寸 Chip Size (mil)	12*12
光源数量 Light Source Quantity (pcs)	20
光源光效 Luminous Efficiency (Lm/W)	90-130
显色指数 CRI	—
色 温 Color Temp (k)	R / Y / G / B / W
环境温度 Environment Temperature (°C)	-40~45
使用寿命 Lifespan (h)	30000-80000



LED 流星雨

LED Meteor Shower



产品特点 Product Features

流星效果，浪漫唯美；外带驱动，低压供电，可根据需求任意增减灯管数量，随意发挥；防水、防尘、防腐蚀，不受时间、空间限制。

Meteor effect, romantic and aesthetic, external driving, low-voltage power supply, the quantity can be added or reduced according to the demand. Waterproof, dustproof, corrosion resistance, without time and space limited.

应用场合 Applications

市场工程亮化, 建筑装饰、街道两旁树木装饰、公园装饰、江边装饰、城市夜景亮化, 旅游景点美化, 园林、社区夜晶装饰, 酒店、商场、娱乐场所周边环境夜景装饰, 家居装饰.

Apply to market engineering lighting, decoration of architecture, street, park and river, urban night lighting, scenic spot lighting, community night scene, garden, hotel, shopping mall, decorative lighting of entertainment place and home decoration.

规格参数 Specifications

材 料 Material	FR-4
防护等级 IP Rating	IP65
功 率 Power (W)	0.3W
输入电压 Input Voltage (V)	24
光源类型 Light source Type	DIP LED
芯片尺寸 Chip Size (mil)	12*12
光源数量 Light Source Quantity (pcs)	30
光源光效 Luminous Efficiency (Lm/W)	90-130
显色指数 CRI	—
色 温 Color Temp (k)	R / Y / G / B / W
环境温度 Environment Temperature (°C)	-40~45
使用寿命 Lifespan (h)	30000-80000

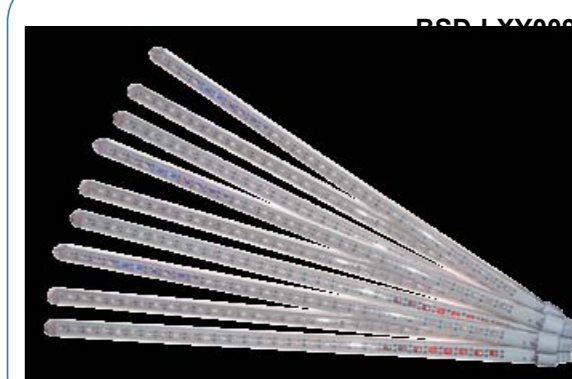

外形尺寸图 Dimension Diagram

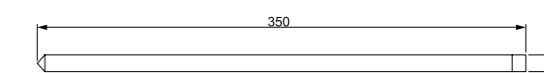

包装参数 Packaging Parameters

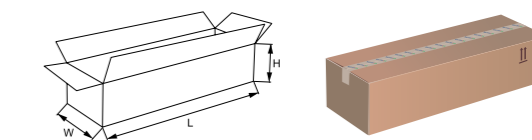

Item	Size(mm)	包装数量 Qty	外箱尺寸 Carton Size
BSD-LXY009		10PCS	570L×340W×220H



LED 流星雨

LED Meteor Shower

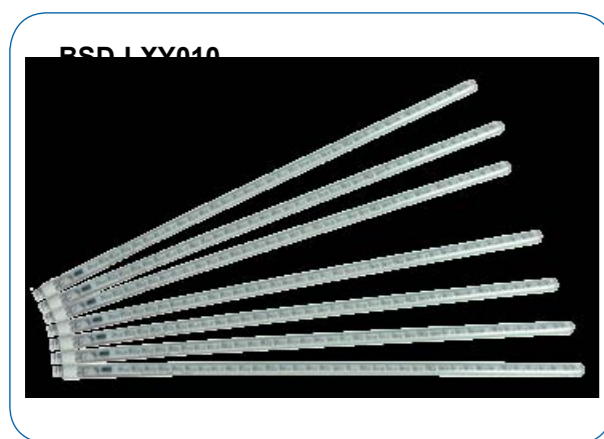

外形尺寸图 Dimension Diagram

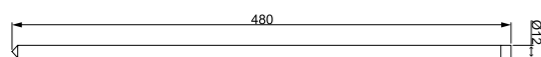

包装参数 Packaging Parameters

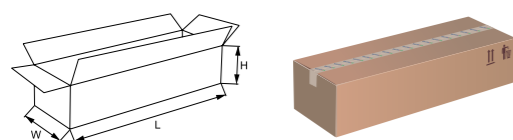

Item	Size(mm)	包装数量 Qty	外箱尺寸 Carton Size
BSD-LXY010		10PCS	570L×340W×220H

产品特点 Product Features

流星效果, 浪漫唯美; 外带驱动, 低压供电, 可根据需求任意增减灯管数量, 随意发挥; 防水、防尘、防腐蚀, 不受时间、空间限制。

Meteor effect, romantic and aesthetic, external driving, low-voltage power supply, the quantity can be added or reduced according to the demand. Waterproof, dustproof, corrosion resistance, without time and space limited.

应用场合 Applications

市场工程亮化, 建筑装饰、街道两旁树木装饰、公园装饰、江边装饰、城市夜景亮化, 旅游景点美化, 园林、社区夜晶装饰, 酒店、商场、娱乐场所周边环境夜景装饰, 家居装饰。

Apply to market engineering lighting, decoration of architecture, street, park and river, urban night lighting, scenic spot lighting, community night scene, garden, hotel, shopping mall, decorative lighting of entertainment place and home decoration.

规格参数 Specifications

材 料 Material	FR-4
防护等级 IP Rating	IP65
功 率 Power (W)	0.35W
输入电压 Input Voltage (V)	24
光源类型 Light source Type	DIP LED
芯片尺寸 Chip Size (mil)	12*12
光源数量 Light Source Quantity (pcs)	35
光源光效 Luminous Efficiency (Lm/W)	90-130
显色指数 CRI	—
色 温 Color Temp (k)	R / Y / G / B / W
环境温度 Environment Temperature (°C)	-40~45
使用寿命 Lifespan (h)	30000-80000

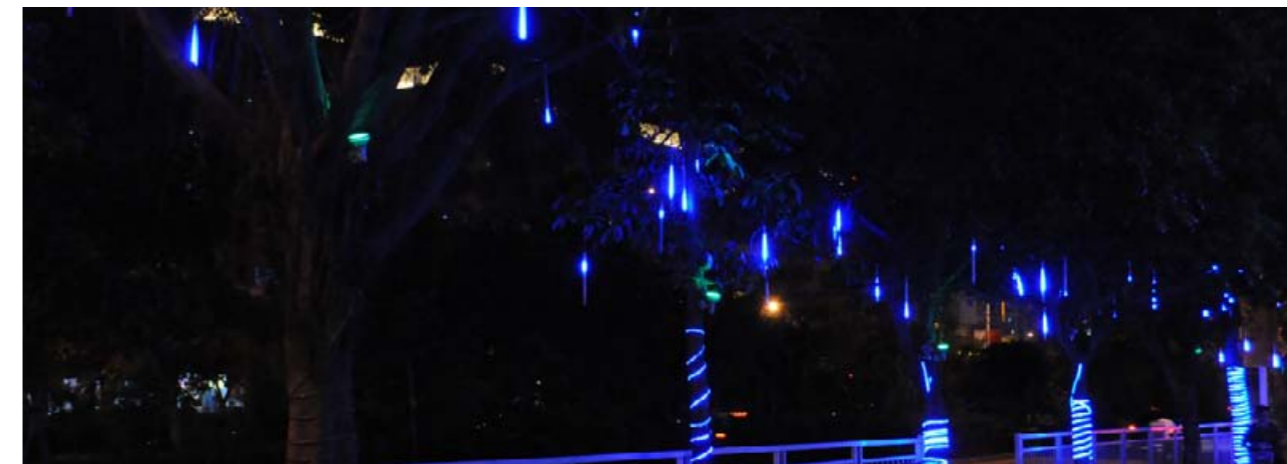

产品特点 Product Features

流星效果, 浪漫唯美; 外带驱动, 低压供电, 可根据需求任意增减灯管数量, 随意发挥; 防水、防尘、防腐蚀, 不受时间、空间限制。

Meteor effect, romantic and aesthetic, external driving, low-voltage power supply, the quantity can be added or reduced according to the demand. Waterproof, dustproof, corrosion resistance, without time and space limited.

应用场合 Applications

市场工程亮化, 建筑装饰、街道两旁树木装饰、公园装饰、江边装饰、城市夜景亮化, 旅游景点美化, 园林、社区夜晶装饰, 酒店、商场、娱乐场所周边环境夜景装饰, 家居装饰。

Apply to market engineering lighting, decoration of architecture, street, park and river, urban night lighting, scenic spot lighting, community night scene, garden, hotel, shopping mall, decorative lighting of entertainment place and home decoration.

规格参数 Specifications

材 料 Material	FR-4
防护等级 IP Rating	IP65
功 率 Power (W)	0.3W
输入电压 Input Voltage (V)	220
光源类型 Light source Type	DIP LED
芯片尺寸 Chip Size (mil)	12*12
光源数量 Light Source Quantity (pcs)	30
光源光效 Luminous Efficiency (Lm/W)	90-130
显色指数 CRI	—
色 温 Color Temp (k)	R / Y / G / B / W
环境温度 Environment Temperature (°C)	-40~45
使用寿命 Lifespan (h)	30000-80000

LED 流星雨

LED Meteor Shower

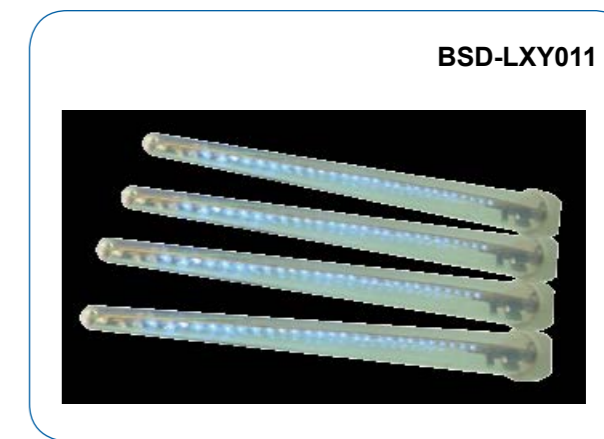

外形尺寸图 Dimension Diagram

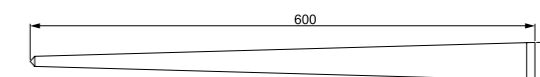

包装参数 Packaging Parameters

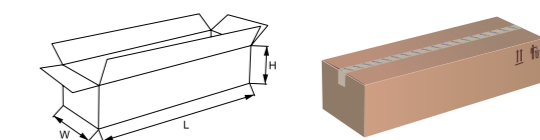

Item	Size(mm)	包装数量 Qty	外箱尺寸 Carton Size
BSD-LXY011		25PCS	650L×215W×210H